

## LASER TRACKING DEVICE B-SNIPER 01 (AMADA/PROMECAM STANDARD)

To be installed on the intermediary of your press brake, it gives immediate speed and precision to your work.

- *How many pieces did you throw away this year?*
- *How much time have you wasted?*
- *How much money did you not collect because of this?*

With B-Sniper 01 **no more positioning errors** even with large radius punches.

Especially with large pieces, diamonds, calendaring and irregular or conical shapes B-Sniper 01 is an unbeatable tool:

**UP TO MORE  
THAN 67% OF TIME SAVED  
IN POSITIONING**

*(data based on real tests and simulations)*

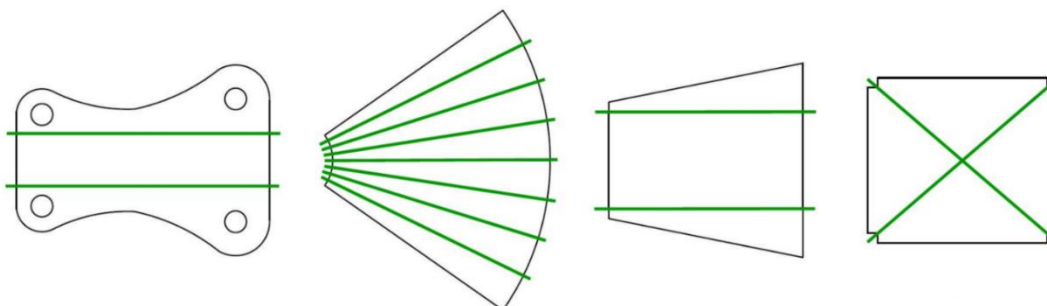

Mounted on the intermediary, B-Sniper 01 traces a **high visibility laser beam on the piece to be bent** to simulate the bending line. All that remains for the operator is to **match the references drawn on the piece to the line projected by B-Sniper 01.**

The peculiarity of B-Sniper 01 is to have the **upper part in the shape of a tool** with the consequent possibility of being mounted if necessary on all machines with the compatible standard.

WATCH THE VIDEO



WATCH THE VIDEO

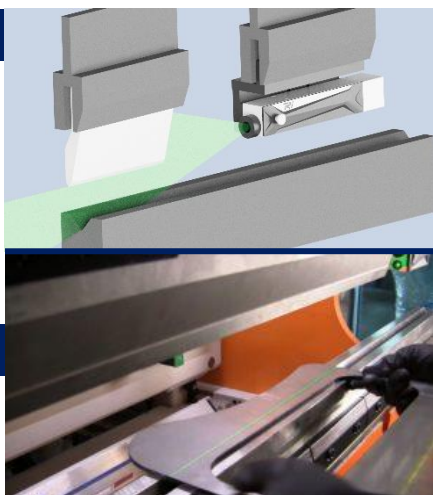

Another great advantage of B-Sniper 01 is the possibility to **work even on very large machines** with two possibilities:

- **SINGLE:** with a single device perfectly centered
- **TWIN:** with two mirrored devices

This is possible as B-Sniper 01 has a symmetrical and reversible body and can, therefore, be reversed at will and **emit the beam from left to right and vice versa.**

Equipped with rechargeable batteries and battery charger, B-Sniper 01 is **very easy to install** on the intermediary of your press brake and is **immediately ready for use.**

## LASER TECHNICAL FEATURES

Wavelength: 532nm  
Power output: <5mW,  
Output mode: continuous  
Input voltage: 3,7 V DC  
Operating current: < 300mA (<600mA per il 50mW)  
Operating temperature: 20°C-30°C  
Beam: linear (90° opening)  
Divergence: 1.4mrad  
Medium life: >4000 hours  
Casing material: brass  
Length: 31mm  
Diameter: 12mm

## TECHNICAL CHARACTERISTICS OF THE BATTERY CHARGER

Keenstone 26650 Universal Battery Charger 2 Slot  
Display LCD  
Provided Nr. 2 Rechargeable Batteries  
Bateries: Li-Ion SAMSUNG INR18650-35E 3,6V 3000mAh

## BEAM VISIBILITY DURATION

Continuous duration: 10 hours  
Batteries supplied: nr.2  
Battery life supplied: 10 hours each

## TRIVENETA IMPIANTI S.r.l.

Administrative Headquarters: Via Scopella, 22 - 37060 Castel d'Azzano VR - Italy  
Operational Headquarters: Via Bovolino, 18/B - 37060 Buttapietra VR - Italy

Phone: +39 045 518 747 - Fax +39 045 854 56 05 - Web Site: [www.trivenetaimpianti.com](http://www.trivenetaimpianti.com) - E-mail: [sales@trivenetaimpianti.com](mailto:sales@trivenetaimpianti.com)

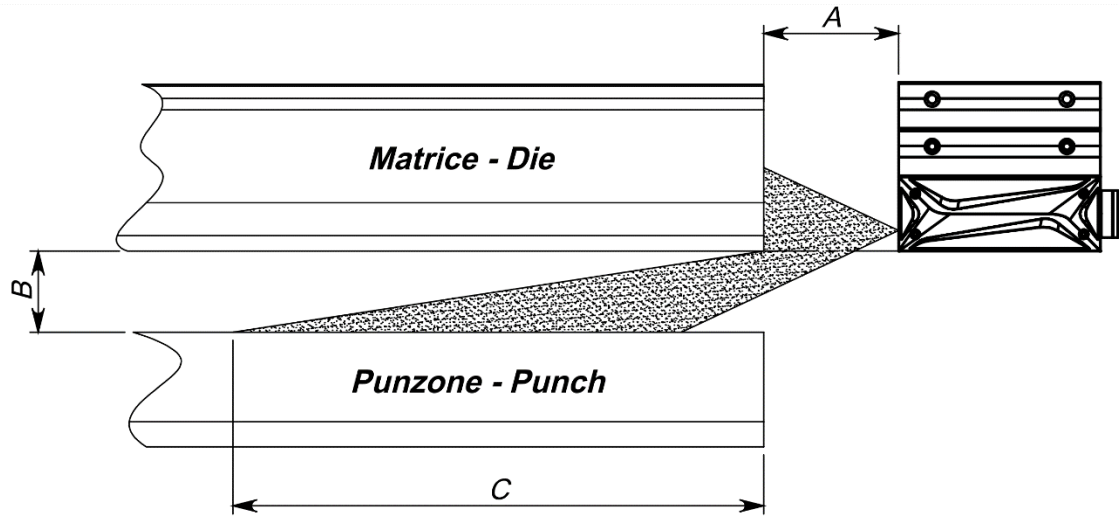

	<b>B 100</b>	<b>B 150</b>	<b>B 200</b>
<b>A 100</b>	C 900	C 1300	C 1800
<b>A 200</b>	C 1800	C 2800	C 3600
<b>A 300</b>	C 2800	C 4200	C 5500

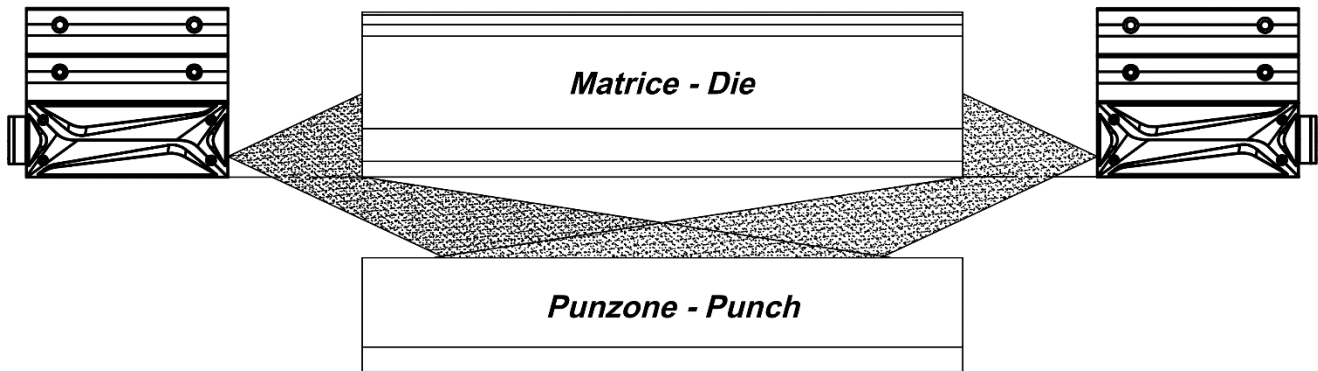
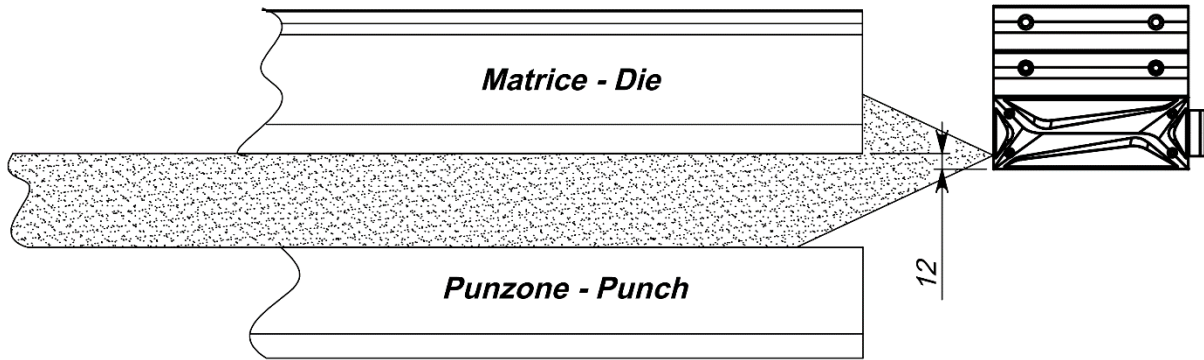



TRIVENETA SISTEMI

# B-SNIPER 01

COD. 024 01

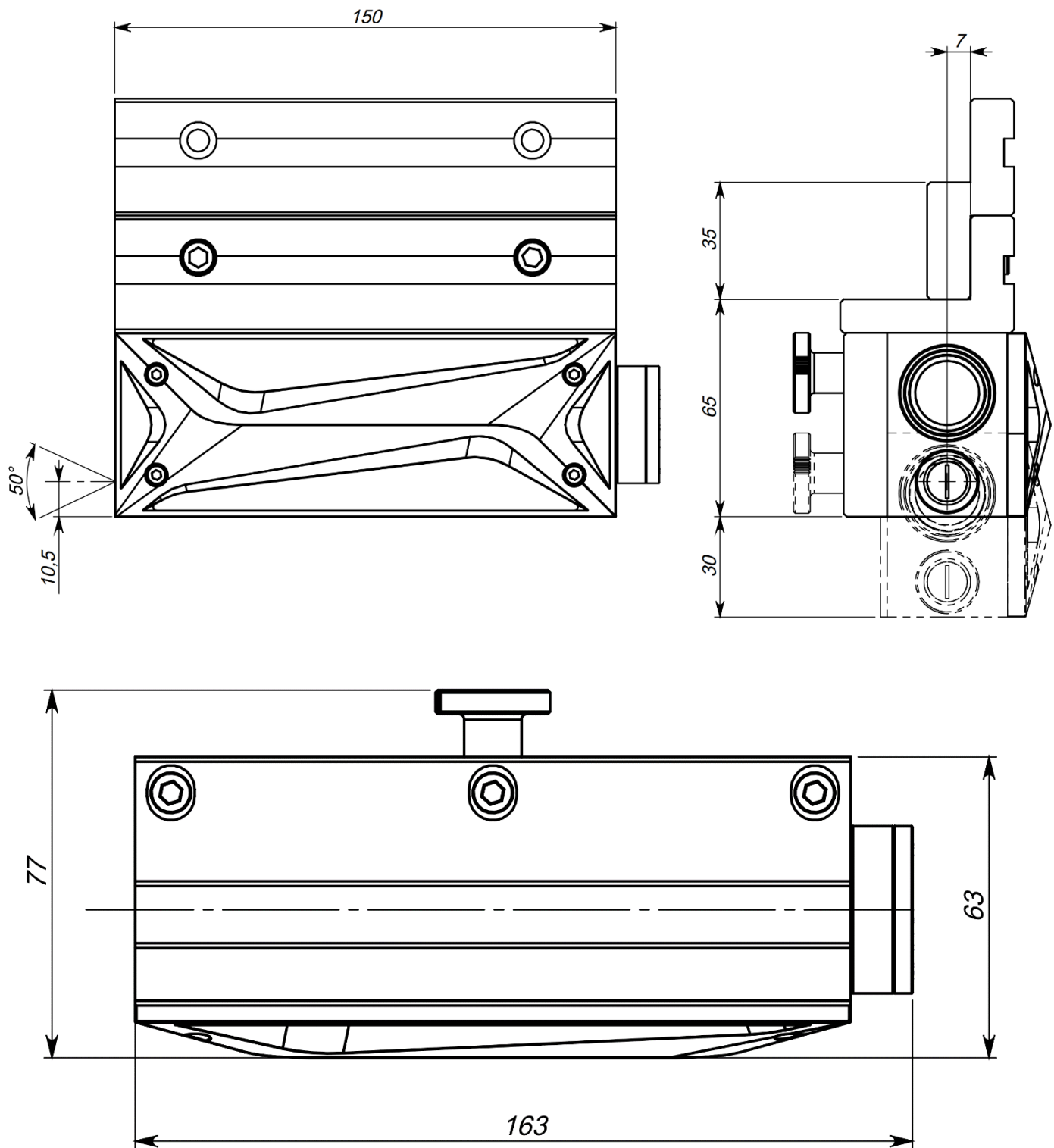

## TRIVENETA IMPIANTI S.r.l.

Administrative Headquarters: Via Scopella, 22 - 37060 Castel d'Azzano VR - Italy

Operational Headquarters: Via Bovolino, 18/B - 37060 Buttapietra VR - Italy

Phone: +39 045 518 747 - Fax +39 045 854 56 05 - Web Site: [www.trivenetaimpianti.com](http://www.trivenetaimpianti.com) - E-mail: [sales@trivenetaimpianti.com](mailto:sales@trivenetaimpianti.com)

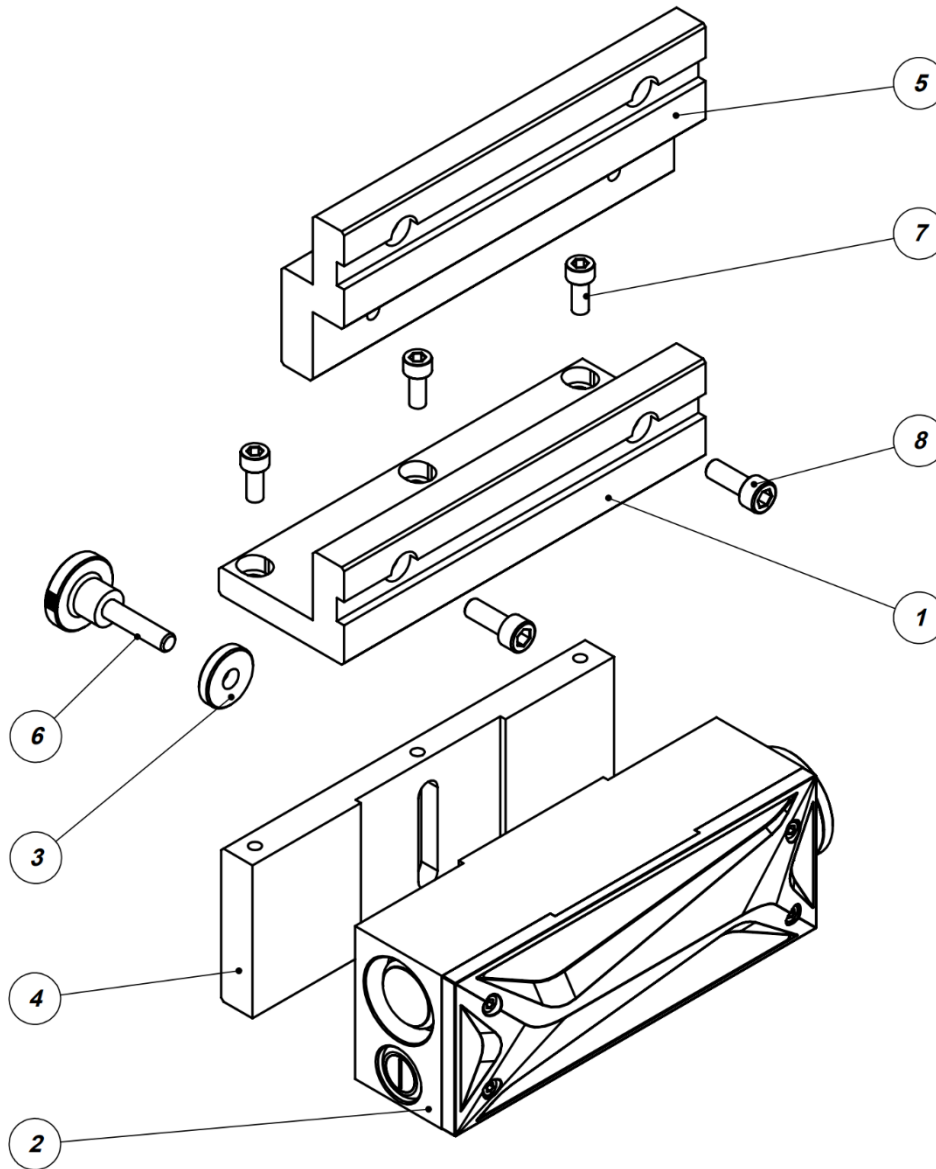

Pos	Codice	Descrizione	Q.tà
1	25072122	Piastra superiore	1
2	25072001	Laser Sniper	1
3	25072117	Rondella	1
4	25072123	Piastra laterale	1
5	25072124	Prolunga 100-130	1
6	90100223	Manopola DIN 464 M6x25 GN.29729	1
7	90020516	Vite TCEI M 5 x 12 UNI 5931 inox	3
8	90020602	Vite TCEI M 6 x 16 UNI 5931 inox	2